

PARTS LIST

No.	PART NAME	QTY	RAW MATERIAL
1	Spray Valve	1	Stainless steel&Brass&POM
2	Flexible Hose	1	Stainless steel
3	Ring	1	Stainless steel
4	Finger Hook	1	Stainless steel
5	Riser Pipe	1	Stainless steel
6	Wall Bracket	1	Stainless steel
7	Main Body	1	Brass & Zinc alloy
8	Swing Nozzle	1	Stainless steel
9	Add-on Faucet	1	Brass
10	3"Tube	1	Stainless steel
11	Spare Kit	1	Metal&Plastic

ATTENTION:

Why faucet leak?

- Missing one or more washers (A1/A2/B/C/E)
- Broken or incorrect washers (A1/A2/B/C/E) inside
- Loose connections

How to do when leaking?

First of all, try to fix the connections tight where leaking.

If not work, pls disassemble the leakage position and check if washers is missing/broken/incorrect.

And then put the corresponding washer inside or replace with a new one .

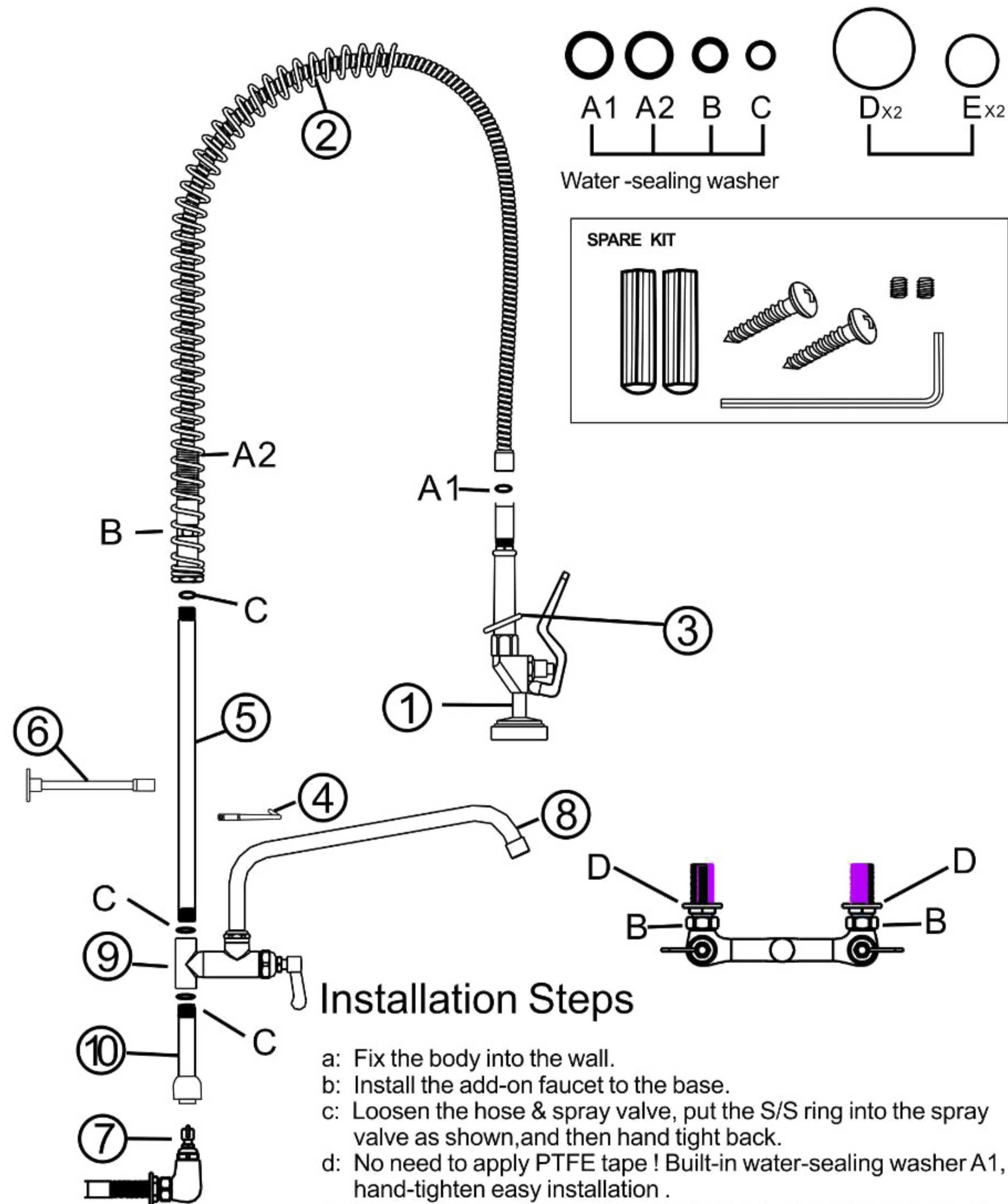
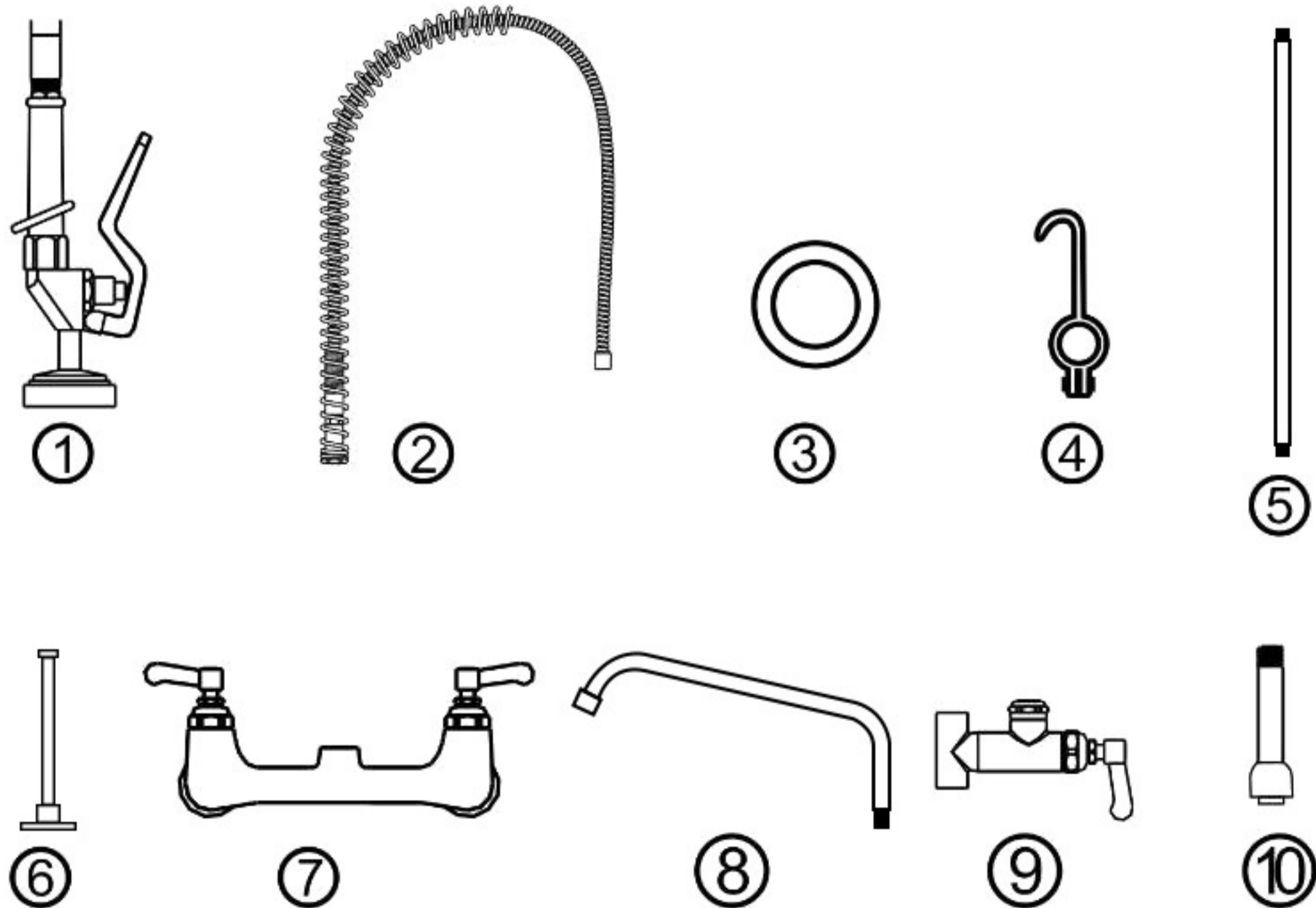

Installation Steps

- Fix the body into the wall.
- Install the add-on faucet to the base.
- Loosen the hose & spray valve, put the S/S ring into the spray valve as shown, and then hand tight back.
- No need to apply PTFE tape ! Built-in water-sealing washer A1, hand-tighten easy installation .
- Loosen the finger hook & put it into the riser, and then screw it.
- Use the Mini allen key provided in accessory bag to loose the wall bracket and fix it to the riser , then screw it tight.
- Hand tight the hose onto the riser. Be careful not to lost the seal washer A2/B/C inside.
- Press down the riser into the body and hand-tighten the locking nut.
- Fix the wall bracket on the wall, the bracket can be cut to length.